

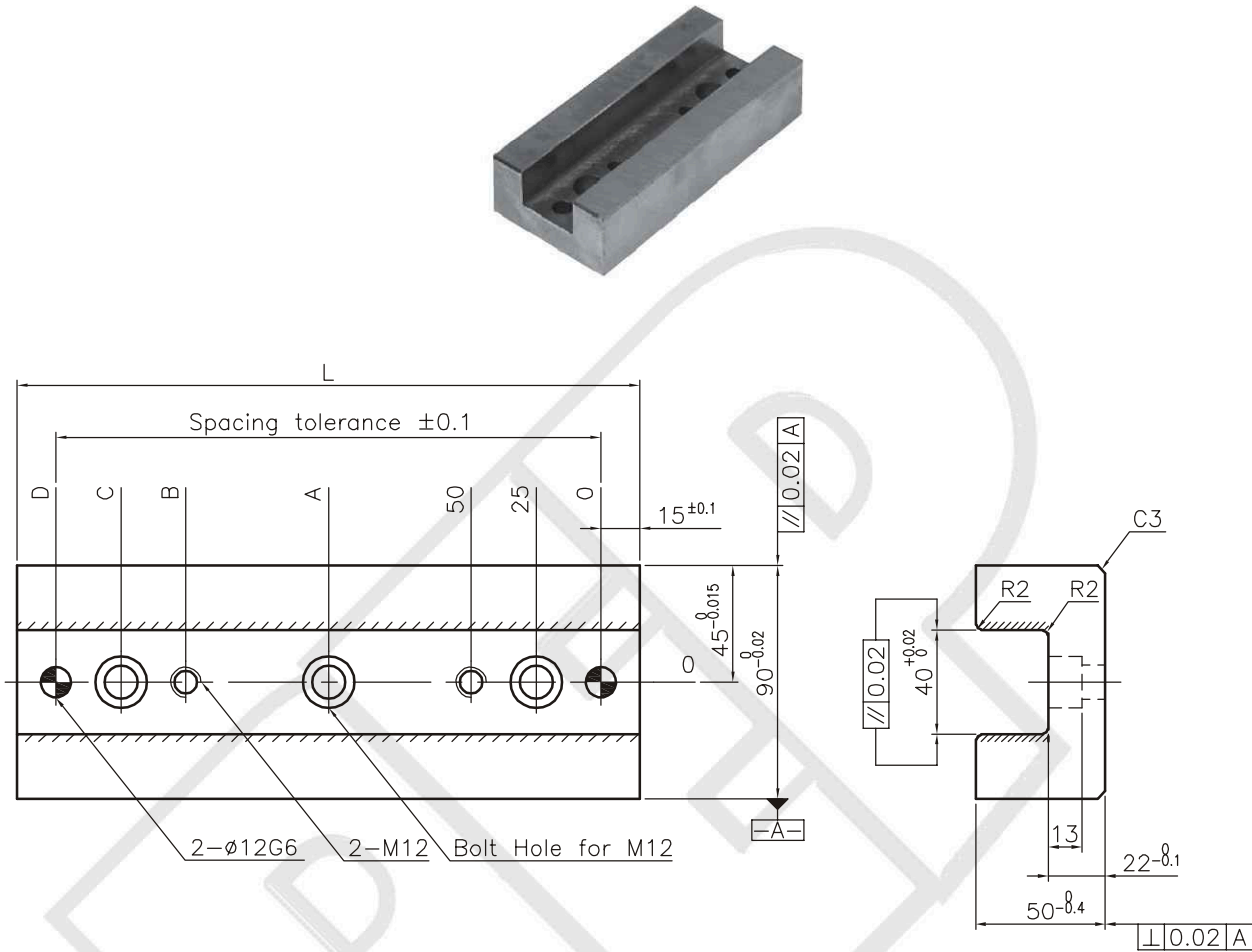

Cam Slide Guide Center Key Guide

G41 (Steel Type)



M Material: 1045 (S45C)
Area to be Induction (Hatched Area)
HRC40 or more

NO. of Mounting Holes	A	B	C	D	L	NAAMS Code	Part Name	
							Series Name	No.
2	-	120	145	170	200	G419020	G41	9020
3	135	220	245	270	300	G419030		9030



Cam Slide Guide Center Key Guide

G42 (Steel with Graphite) / G43 (Bronze with Graphite)

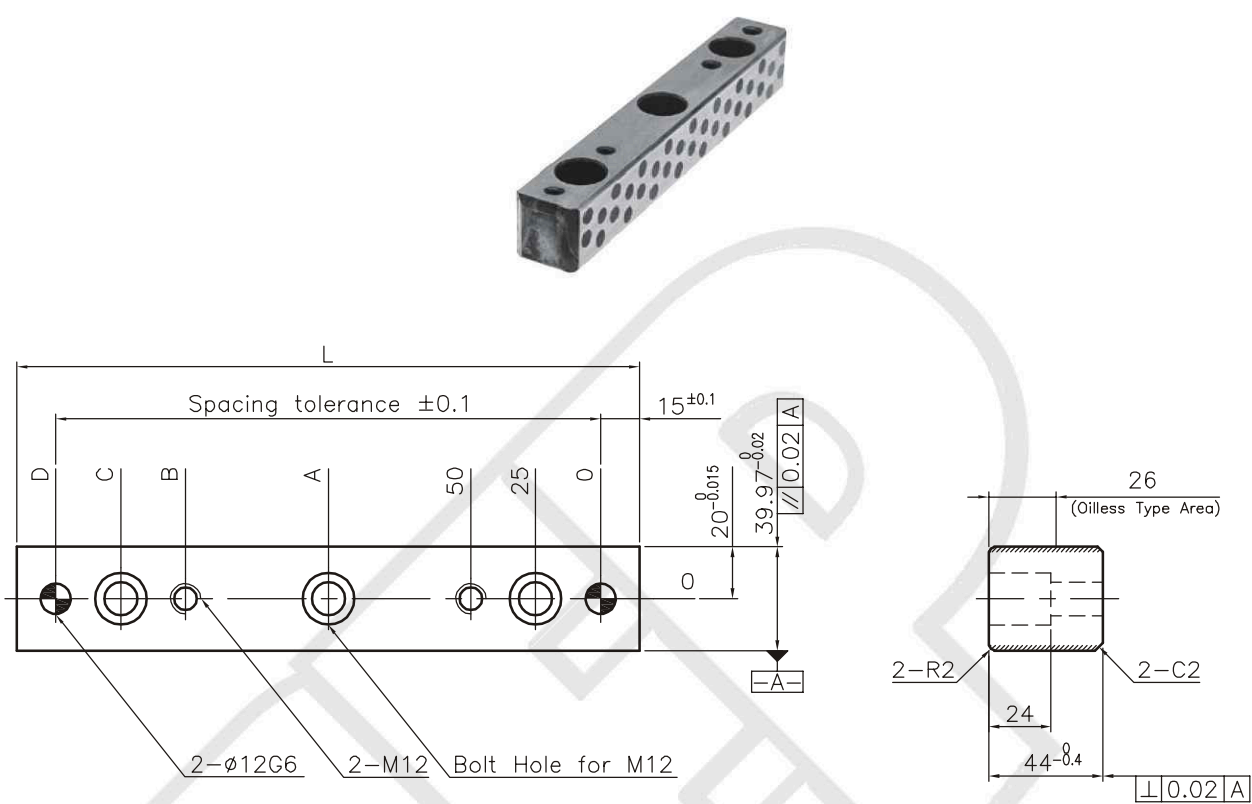

M Material: G42 - 1045 (S45C) with Graphite
Area to be Induction Hardened (Hatched Area)
HRC40 or more
G43 - Bronze with Graphite (SO#50 SP2)

NO. of Mounting Holes	A	B	C	D	L	NAAMS Code		Part Name	
						Steel Type	Bronze Type	Series Name	No.
2	-	120	145	170	200	G424020	G434020	G42 G43	4020
3	135	220	245	270	300	G424030	G434030		4030