

Z4-12 Latch Lock

Characteristics: Installation and processing are simple. Design of mechanical interlock is safe and reliable. Connecting body and square positioning make product more accurate. People can select corresponding product according to die load. There shall be at least 2 sets on template for symmetrical use. Operating temperature range is 120°C.

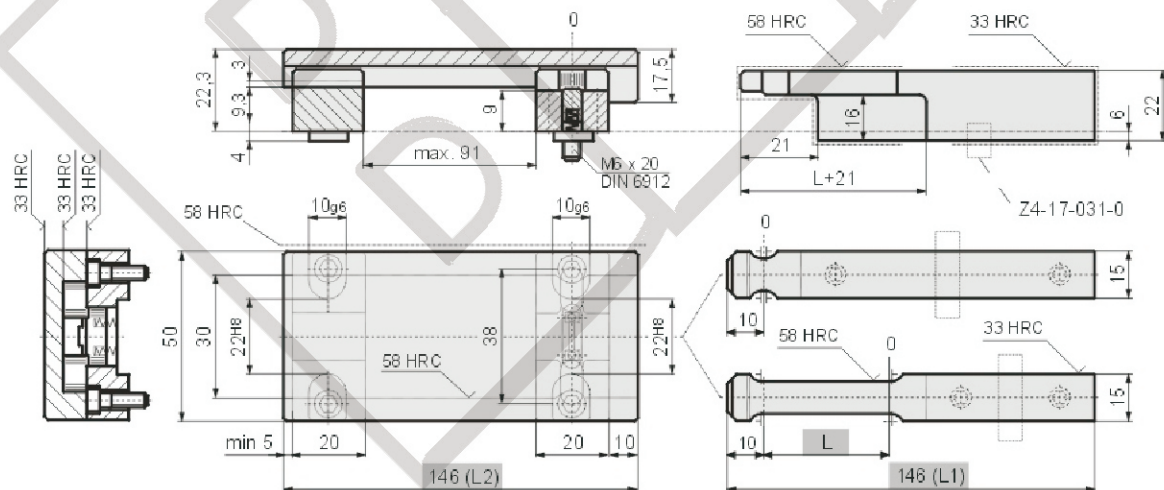

Z 4-12-0-0	L = 0	Z 4-12-50-0	L = 0-50
Z 4-12-25-0	L = 0-25	Z 4-12-75-0	L = 0-75

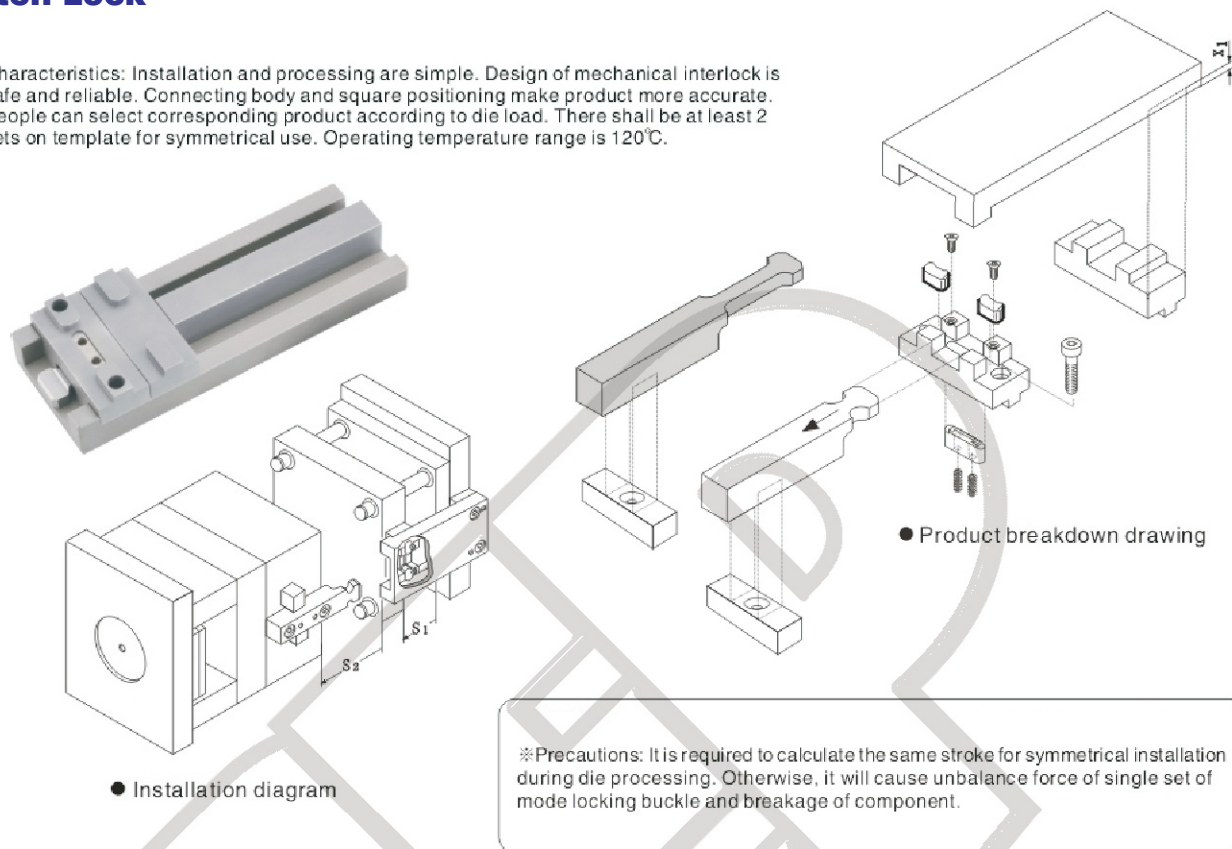

Order: Type No. x Pcs
Z 4-12-0-0 x 10

Mould Lock Components

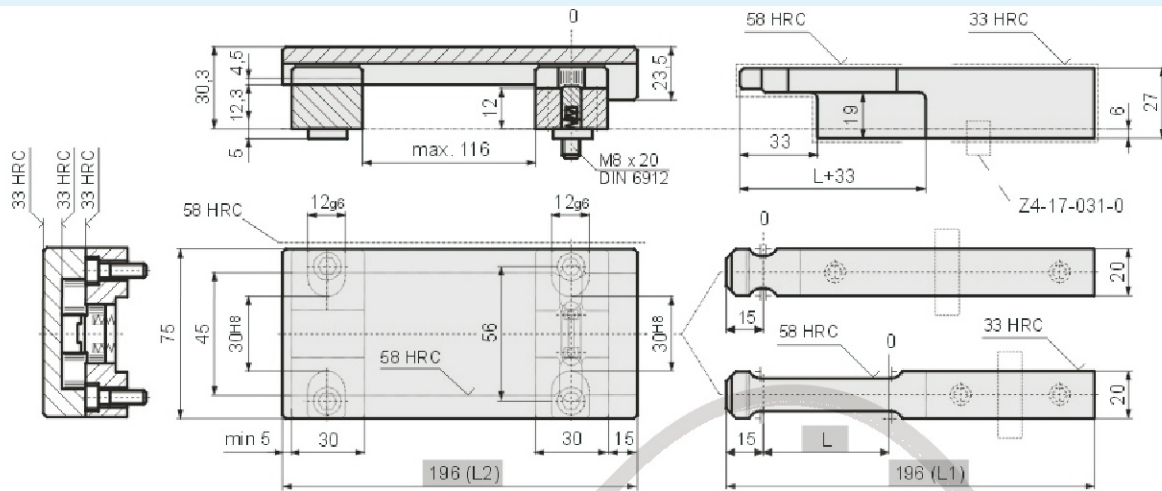

Z 4-17-0-0	L = 0	Z 4-17-50-0	L = 0-50
Z 4-17-25-0	L = 0-25	Z 4-17-75-0	L = 0-75



Order: Type No. x Pcs
Z 4-17-0-0 x 10

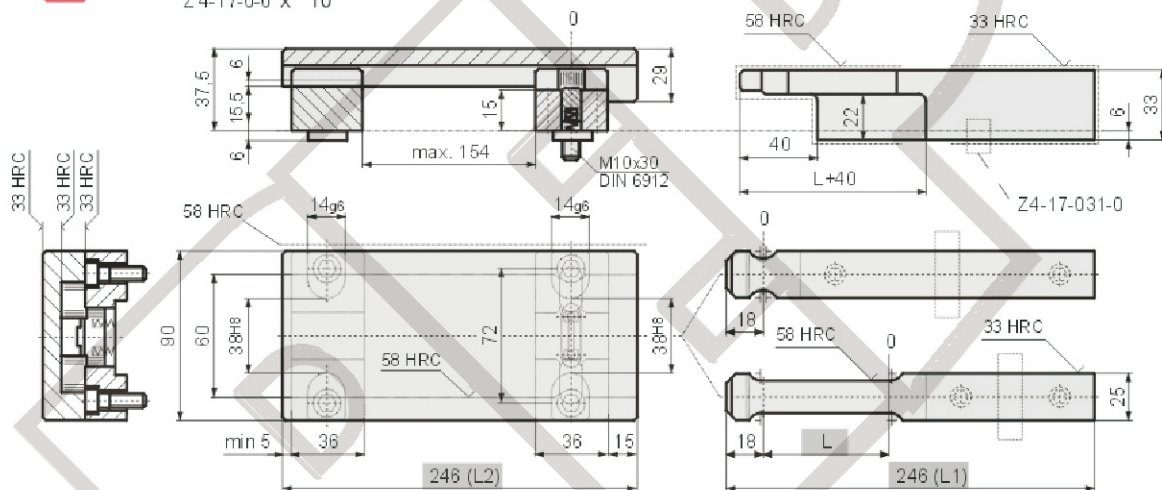

Z 4-22-0-0	L = 0	Z 4-22-50-0	L = 0-50
Z 4-22-25-0	L = 0-25	Z 4-22-75-0	L = 0-75



Order: Type No. x Pcs
Z 4-22-0-0 x 10

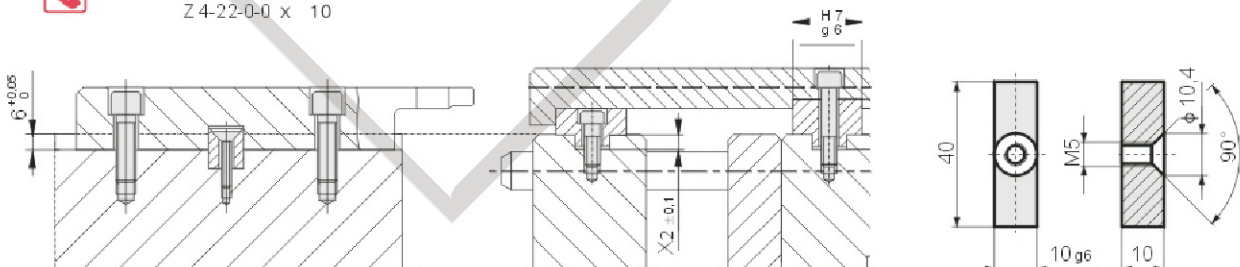

Type	X1	X2
Z 4 - 12	3	4.5
Z 4 - 17	4.5	4.5
Z 4 - 22	6	6.5

BRAHMADEVI ENGINEERING PRODUCTS

Regd. Office :19, Martand Chowk, INDORE - 452 007 (M.P.) INDIA
Ph. : +91 - 731 - 2720243, Fax : +91 - 731 - 2721554
E-mail : ishan1809@yahoo.com, ruchir@diespares.com Website : www.diespares.com