

Extrusion Series

Sprue bushing A type

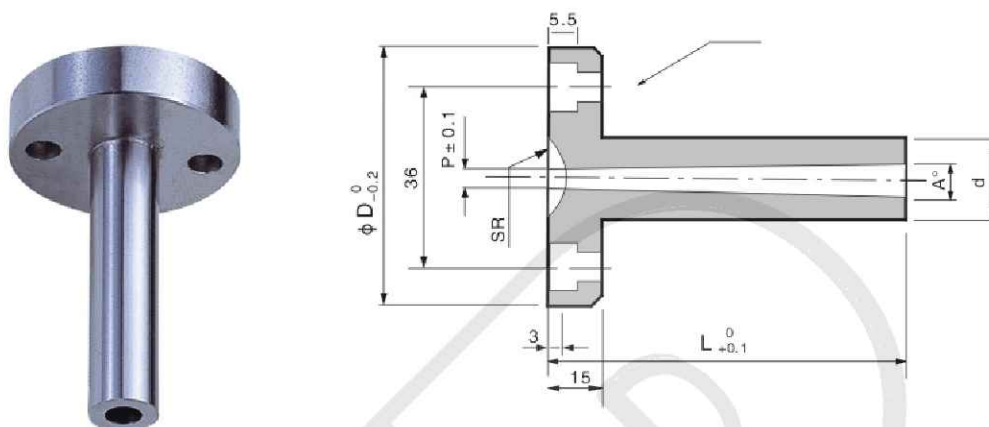

Material	Hardness	Hardness
S45C	HRC50°~55°	
SKD11	HRC60°±2°	HRC60°±2°
SKD61	HRC36°±2°	HRC1000°±100°
	HRC52°±2°	HRC52°±2°

D	B	d			H	L	SR	P	A
			D						
35	25	BT540	12	0 -0.009	10	0~100.0	0	3 3.5 4 4.5 5	1° 2° 3°
			16		15		11		
			20	20	12				
50	36		20	0 -0.011	10	0~150.0	13		
			16		15		0		
			20	0 -0.013	15	0~180.0	11		
			25		20	0~200	12 13 16		

Sprue bushing B type

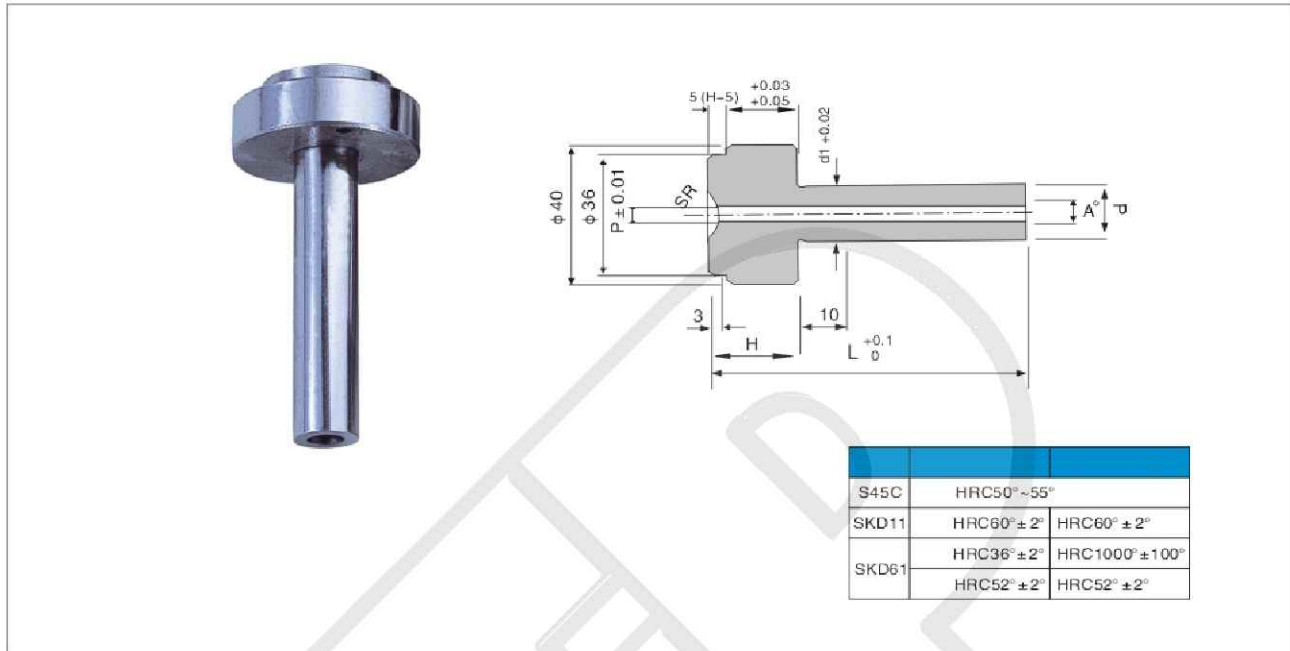

H		D	Dh6	L	SR	P	A
20		12	0 -0.009				
25		16			0		
30		20	0 -0.011	0~150.0	11	3.0	1°
	BT541				12	3.5	2°
20		16			13	4.0	3°
					16	4.5	4°
25		20	0 -0.013		20	5.0	
30		25			21		

Extrusion Series



Sprue bushing C type

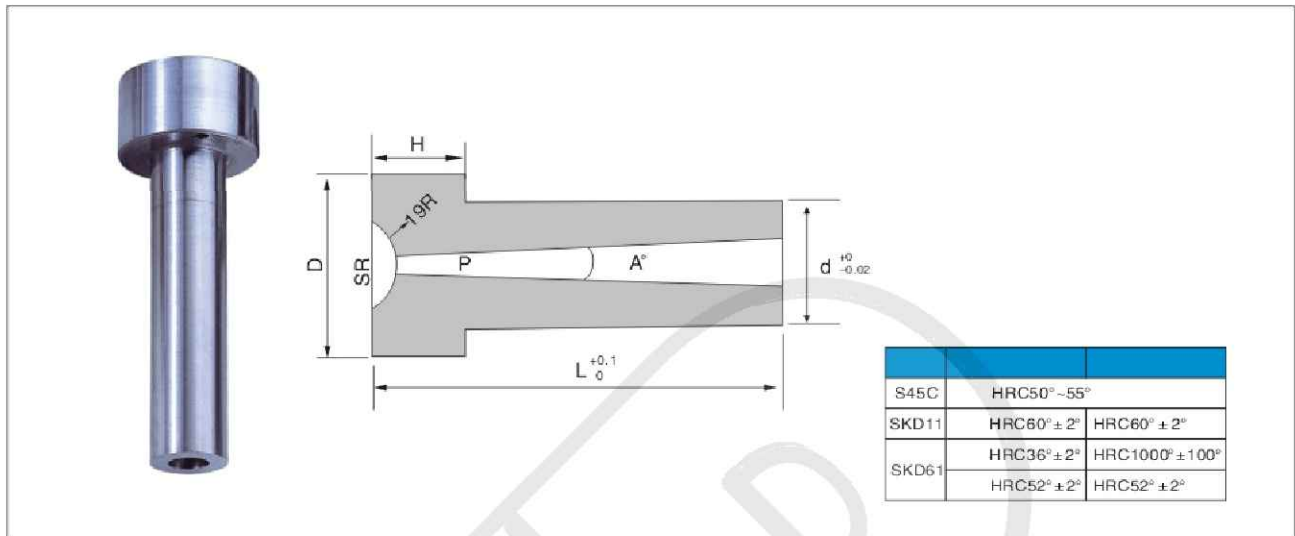

D	H			L	SR	P	A
			d				
25	15	BT542	12	0~150.0	0	3.0	1° 2° 3° 4°
30					11	3.5	
35	20		16		12	4.0	
			20		13	4.5	
					16	5.0	

D	d	L											
		40	50	60	70	80	90	100	110	120	130	140	150
25	12	30	45	60	75	90	105	120	135	150	165	180	195
	16												
30	12	40	55	70	85	100	115	130	150	180	210	240	280
	16												
	20												
35	16	60	75	90	105	120	135	150	170	200	230	260	300
	20												
50	16	80	95	110	125	140	155	170	200	230	260	290	320
	20												
	25												

BRAHMADEVI ENGINEERING PRODUCTS

Regd. Office :19, Martand Chowk, INDORE - 452 007 (M.P.) INDIA
 Ph. : +91 - 731 - 2720243, Fax : +91 - 731 - 2721554
 E-mail : ishan1809@yahoo.com, ruchir@diespares.com Website : diespares.com

Locating rings A type

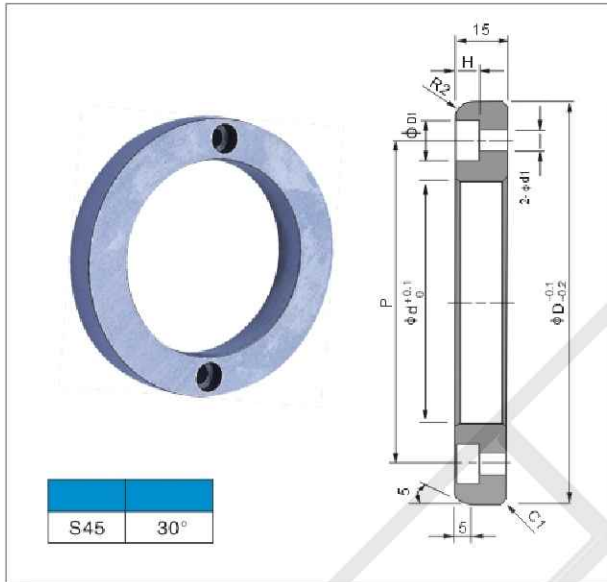

Locating rings B type

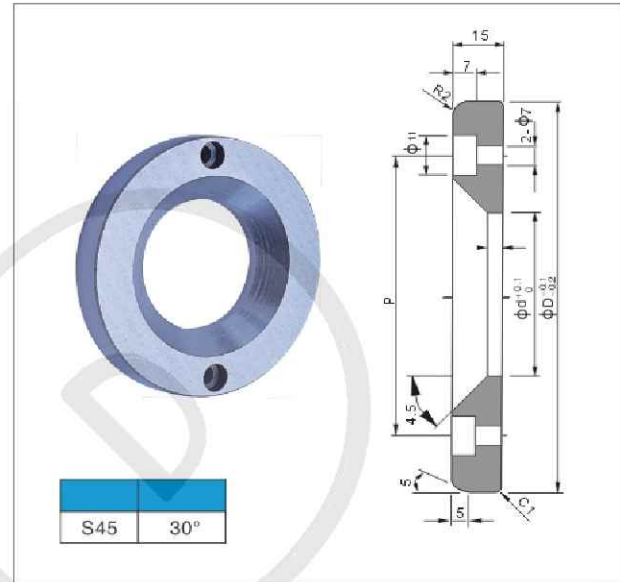

	D	d	d1	D1	H	P	
BT549	60	36	4.5	7.3	4.5	48	31
	100	70				85	40
	120	90	7	11	7	105	45
	150	110	9.5	15	9	130	55

	D	d	P	
BT550	100	36	85	44
		50		
	120	36	85	55
		50		

Shoulder Sprue Bushing

SKH51



SKH51	59-61HRC
-------	----------

1A

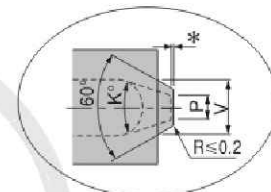
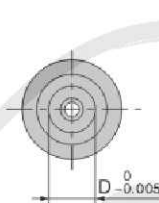
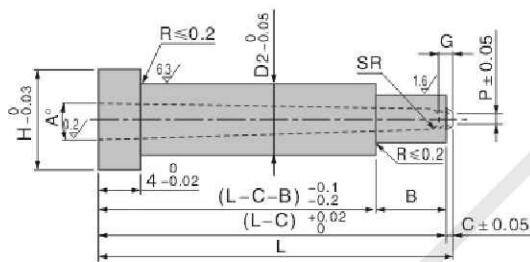

2A

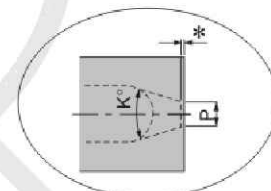
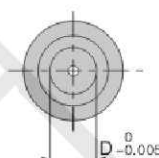
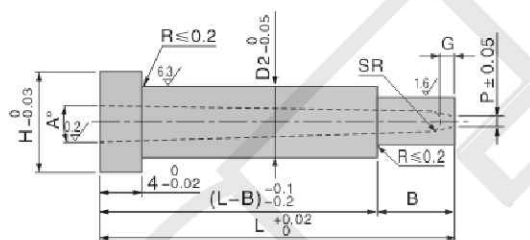

3A

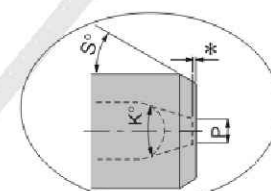
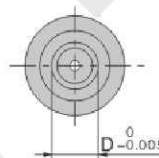
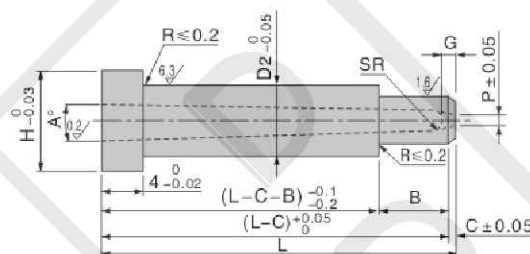

4A

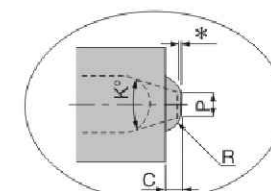
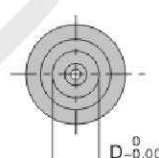
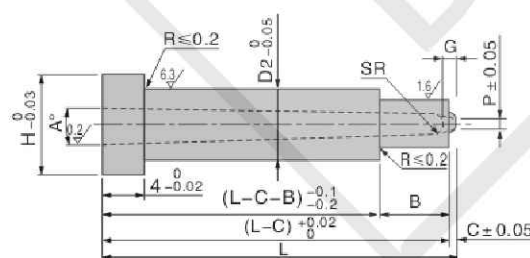

5A

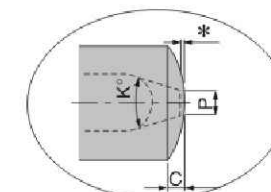
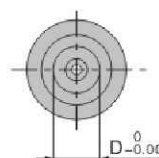
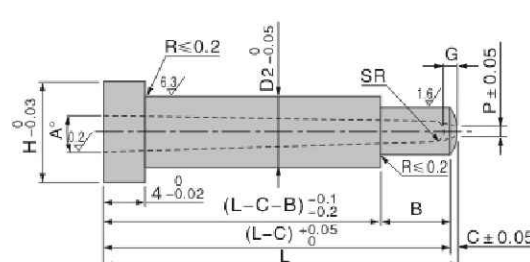

Extrusion Series

Shoulder Sprue Bushing

Code No.			0.01mm	P	A°	K°	<u>2A</u>	<u>1A</u>	<u>3A</u>	<u>4A</u>	H	D ₂	G	B	SR		
Code	Shape	D	L				0.1mm	0.1mm	1°	0.1mm							
							C	V	S°	R							
BT543	1A 2A 3A 4A 5A	3	30.00~40.00	0.5 0.6 0.8	1	20	0.3~0.8	2.0~2.9	1~45	0.8~1.5	8	5	1.2	6	1.00		
		4		0.6				2.5~3.9			11	8			9	6	1.00
				0.8 1.0													1.25
		5	30.00~60.00	0.8 1.0			0.5~1.5	3.5~4.9		1.0~2.0	12	9	1.5	10	1.25		
				1.2											1.50		
		6		1.0				4.0~5.9		1~50	1.5~3.0	14	11	1.50			
				1.2 1.4					4.5~7.9						1~50	2.0~4.0	
				1.2 1.4													
				1.6													

Code No.		L	@/P(1~4P)				
Code	D		1A	2A	3A	4A	5A
BT543	3	30.00~40.00	16,150	14,730	15,010	16,150	16,150
	4	30.00~40.00	17,010	15,580	15,870	17,010	17,010
	5	30.00~40.00	15,390	13,970	14,250	15,390	15,390
		40.01~60.00	15,770	14,350	14,630	15,770	15,770
	6	30.00~40.00	15,390	13,970	14,250	15,390	15,390
		40.01~60.00	15,770	14,350	14,630	15,770	15,770
	8	30.00~40.00	15,680	14,250	14,540	15,680	15,680
		40.01~60.00	16,150	14,730	15,010	16,150	16,150

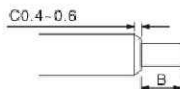
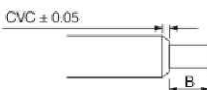
Add.	Code	Spec.	@/P
	CC		300
	CVC	$0.2 \leq CVC < \frac{(D_2 - D)}{2} - 0.1$ • CVC=0.1mm	1,000

Point Sprue Bushing

SKH51



SKH51	59~61HRC
-------	----------

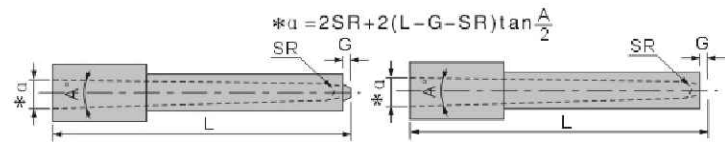

1A

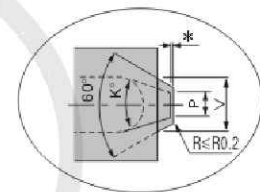
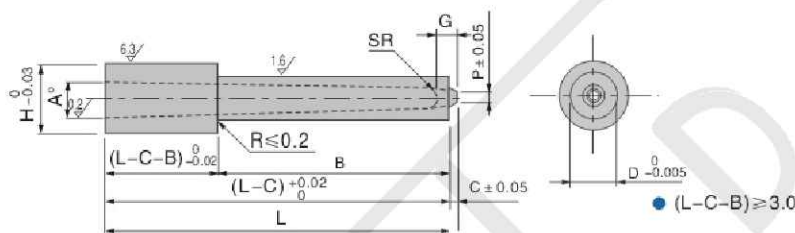

2A

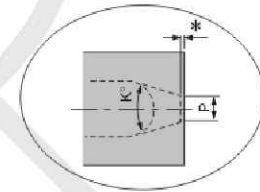
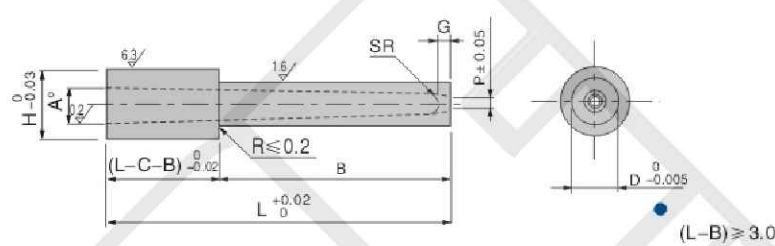

3A

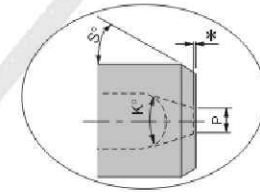
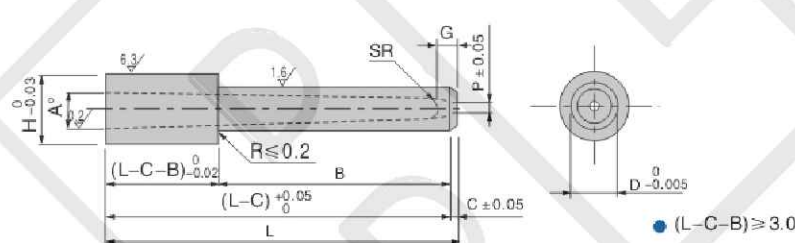

4A

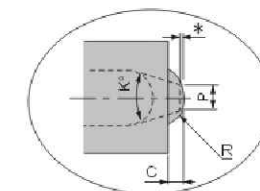
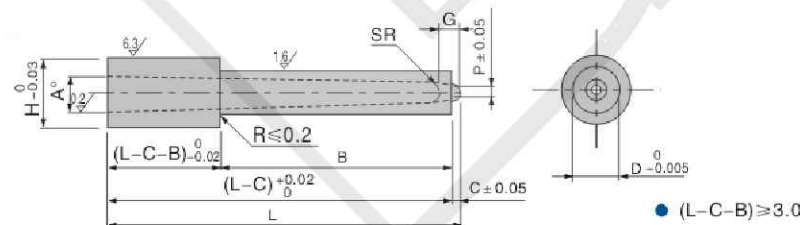

5A

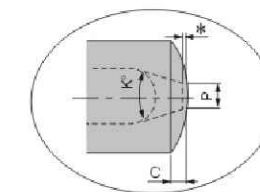
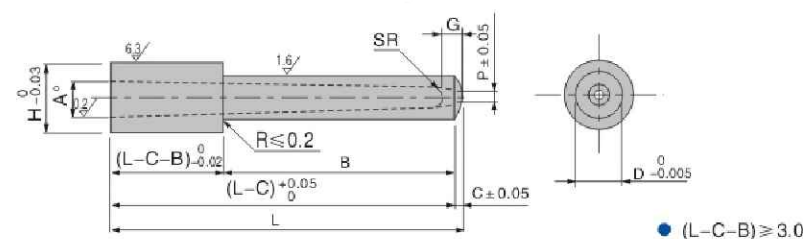

Extrusion Series



Point Sprue Bushing

Code No.			0.01mm	P	A°	K°	B		2A	1A	3A	4A	H	G	SR		
Code	Shape	D					BT 037-1	0.01mm BT 037-2	0.1mm	0.1mm	1°	0.1mm					
									C	V	S°	R					
BT 544-1	1A	2	6.00-20.00	0.3 0.4	1	20	3	3.00-5.00	0.2~0.4	1.3~1.9	1~45	0.4~0.8	3	0.7	0.60		
		2.5	8.00-25.00	0.3 0.4 0.5	2		4	4.00-6.00	0.2~0.5	1.5~2.4		0.6~1.0	4	1	0.75		
					3												
					1												
					2												
					3												
	2A	4	10.00-40.00	0.5 0.6 0.8	1		6	6.00-9.00	0.3~0.8	2.0~2.9		0.8~1.5	5	1.2	1.00		
					2												
					3												
					1												
					2												
					3												
BT 544-2	3A	5	15.00-60.00	0.6	30	6.00-30.00	0.5~1.5	2.5~3.9	1.0~2.0	8	1.5	1.25					
						1											
						2											
						3											
						1											
						2											
	4A	6	1.2	6.00-20.00		0.5~1.5							4.0~5.9	1~50	1.5~3.0	9	1.50
				1													
				2													
				3													
				1													
				2													
5A	8	1.0	6.00-30.00	0.5~1.5	4.0~5.9	1~50	1.5~3.0	9	1.50								
			1														
			2														
			3														
			1														
			2														
5A	8	1.2 1.4	6.00-40.00	0.5~1.5	4.0~5.9	1~50	1.5~3.0	9	1.50								
			1														
			2														
			3														
			1														
			2														
5A	8	1.6	6.00-50.00	0.5~1.5	4.5~7.9	1~60	2.0~4.0	11	2.00								
			1														
			2														
			3														
			1														
			2														

Code No.		D	L	@/P(1~4P)				
Code	Shape			1A	2A	3A	4A	5A
BT 544-1	2	6.00~20.00	18,720	17,290	17,580	18,720	18,720	
		8.00~25.00	18,720	17,290	17,580	18,720	18,720	
	3	10.00~25.00	13,110	11,690	11,970	13,110	13,110	
		25.01~40.00	14,060	12,640	12,920	14,060	14,060	
	4	10.00~25.00	13,400	11,970	12,260	13,400	13,400	
		25.01~40.00	14,160	12,730	13,020	14,160	14,160	
	5	15.00~25.00	12,830	11,400	11,690	12,830	12,830	
		25.01~40.00	13,400	11,970	12,260	13,400	13,400	
	6	40.01~60.00	14,160	12,730	13,020	14,160	14,160	
		15.00~25.00	12,830	11,400	11,690	12,830	12,830	
	8	25.01~40.00	13,400	11,970	12,260	13,400	13,400	
		40.01~60.00	14,160	12,730	13,020	14,160	14,160	
		15.00~25.00	13,020	11,590	11,880	13,020	13,020	
		25.01~40.00	13,680	12,260	12,540	13,680	13,680	
		40.01~60.00	14,540	13,110	13,400	14,540	14,540	

Code No.		D	L	@/P(1~4P)				
Code	Shape			1A	2A	3A	4A	5A
BT544-2	2	6.00~20.00	20,430	19,000	19,290	20,430	20,430	
		8.00~25.00	20,430	19,000	19,290	20,430	20,430	
	3	10.00~25.00	14,250	12,830	13,110	14,250	14,250	
		25.01~40.00	15,300	13,870	14,160	15,300	15,300	
	4	10.00~25.00	14,630	13,210	13,490	14,630	14,630	
		25.01~40.00	15,390	13,970	14,250	15,390	15,390	
	5	15.00~25.00	13,970	12,540	12,830	13,970	13,970	
		25.01~40.00	14,630	13,210	13,490	14,630	14,630	
	6	40.01~60.00	15,390	13,970	14,250	15,390	15,390	
		15.00~25.00	13,970	12,540	12,830	13,970	13,970	
	8	25.01~40.00	14,630	13,210	13,490	14,630	14,630	
		40.01~60.00	15,390	13,970	14,250	15,390	15,390	
		15.00~25.00	14,160	12,730	13,020	14,160	14,160	
		25.01~40.00	14,920	13,490	13,780	14,920	14,920	
		40.01~60.00	15,870	14,440	14,730	15,870	15,870	

Add.	Code	Spec.	@/P
	CC	● D2 · 2.5 C0.2~0.4	300
	CVC	● CVC=0.1mm単位 $0.2 \leq CVC < \frac{(H-D)}{2} - 0.1$	1,000

BRAHMADEVI ENGINEERING PRODUCTS

Regd. Office :19, Martand Chowk, INDORE - 452 007 (M.P.) INDIA
 Ph. : +91 - 731 - 2720243, Fax : +91 - 731 - 2721554
 E-mail : ishan1809@yahoo.com, ruchir@dieaspares.com Website : dieaspares.com